

Nesting Swifts and The Law

It is illegal to disturb swifts, their eggs or their nests during the breeding season of late April until September.

It is illegal to prevent swifts from entering their nest space, so it is important not to erect scaffolding during the breeding season or block access with netting.

Remember that swifts need clear pathways to the nest as they swoop up into and down out of the entrance hole.

Salisbury and Wilton Swifts is here to help you with all aspects of caring for swifts. To find out more about practical solutions, you can contact us at any time.

Telephone: 07940 812511 or 07990 599327

Email: barlow@virtuallyhome.co.uk

Thank you for sharing your home with swifts!

Did you know that you have swifts nesting in your roof?



You are very lucky! Your house is one of the few places left in the area where swifts are known to nest. They are incredible birds, but are in danger of becoming extinct in the UK. Their numbers have dropped by over 60% since 1995.

One of the reasons for this is that swifts need our buildings to nest - they can't nest in trees like other birds. Swifts return to the same nest year after year. But as we renovate our homes we often cover up the tiny crevices they use to access their nests, without being aware that we have done it!

Repairs and re-roofing are unavoidable, but it is easy and cheap to retain nesting places in the process. There are lots of different ways of doing this. Salisbury and Wilton Swifts offer free advice to help you decide which is the easiest and best solution for you.

This leaflet shows you just a few suggestions for you to consider when the time comes...

Keep Existing Nest Spaces Accessible

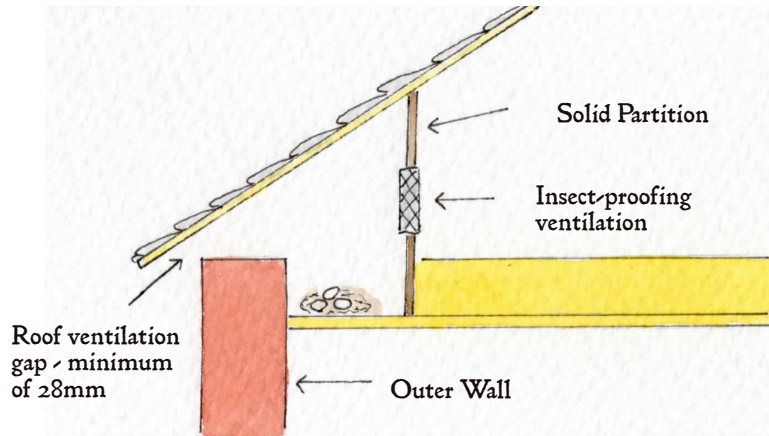

By far the easiest and most effective, this method can also be used to make a new nesting place. The swifts use the ventilation gap which is there to keep air circulating in the loft. A partition can be inserted to prevent swifts entering any further.

Install a Soffit Nest Box

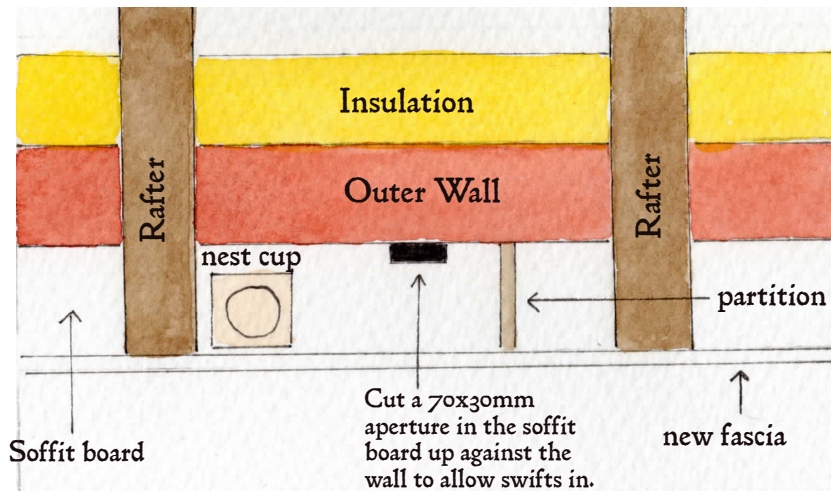

If you are having new soffits fitted, this is an ideal solution. Try to cut the entrance hole as close to the original as possible, and if you are providing more than one nest space, put partitions between them to prevent fights between birds. The nest cup helps the swifts to make a secure place for the eggs to sit.

Install a Swift Brick

A brick nearest the entrance to the nest can be chiselled out and replaced by a box with a brick front, that sits flush with the outer wall, and is surrounded by your existing insulation material. It is completely enclosed.

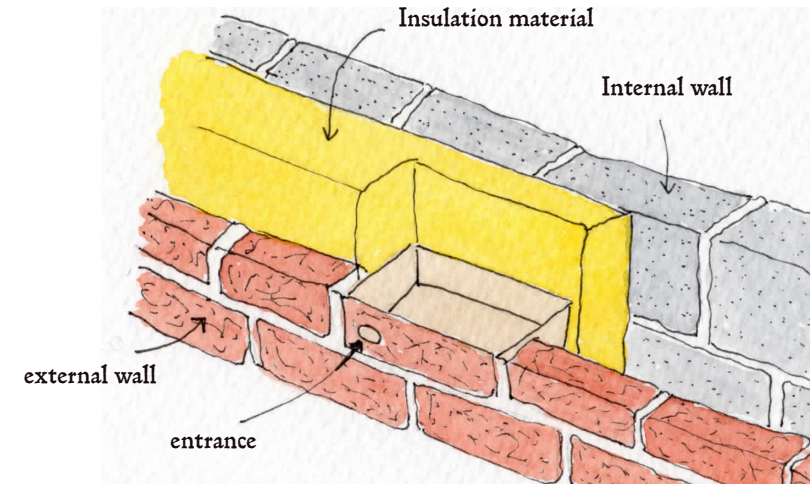

Install an External Nest Box

This is the least effective solution, as swifts that have previously nested under the eaves are less likely to take to an external box. But very worthwhile if all else fails!

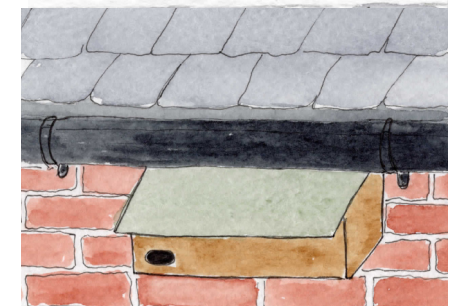

These are just a few ways you can help to preserve existing swifts' nests. We understand that there are many different circumstances that threaten the continuation of a nest site, but there is often an easy solution and we're always happy to help you find it.